



**27 Teal Boulevard Banksia Beach QLD**

5 3 2

Showcasing spectacular, panoramic water views, this single level resort-like-retreat has multiple, flowing entertaining spaces and king sized bedrooms. It exudes beautiful, stylish living and whispers the promise to create your ultimate family lifestyle.

Private yet central, it is so close to all that is offered in Banksia Beach and right on the Broadwater and a world away from care!

- \* Granite & 2 pac island gas kitchen equipped with quality, stainless steel, European appliances, abundant storage, full sized butler pantry
- \* Walls of fold back glass doors open onto idyllic alfresco settings
- \* Cleverly designed with open plan interiors and for lounge/dining options

**Price** : \$ 1,135,000  
**Building Size** : 384.6 sqm  
**View** : <https://www.kdnorth.com.au/sale/qld/red-cliffe-bribie-caboulture/banksia-beach/residential/house/5671119>



**Mark Van Derzeil**  
07 3410 7721

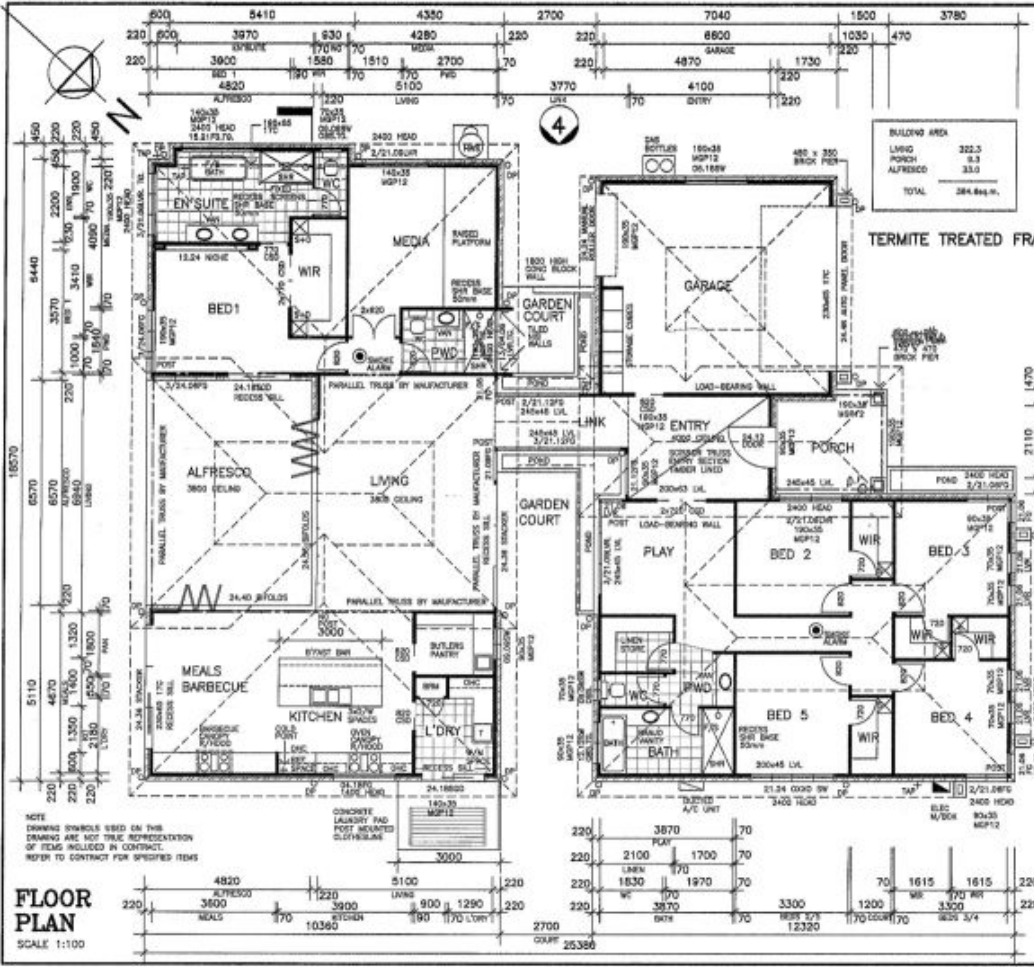

**WARNING**  
 SUB SURFACE ELECTRICAL  
 IN METERS  
 NO WORK TO COME  
 LAYOUT CO  
 APPROVED HARD  
 AREA SAFE

**MANCORP QUALITY HOMES**  
 PG Box 1305  
 Crowsley Qld 4810  
 Office (07) 5482011  
 Fax: (07) 5485377  
 Mob: 555 995 179

**NOTE:**  
 \* ALL CONSTRUCTION TO BE IN ACCORDANCE WITH BUILDING CODE OF AUSTRALIA AND AS 1984.2 - TAPER FRAMING MANUAL.  
 \* WINDOW COSSER SHOWS HEIGHT & WIDTH e.g. 1216 x 1830 HIGH x 1800 WIDE.  
 \* DIMENSIONS TO BE VERIFIED BY CONTRACTORS PRIOR TO PREPARATION OF SHOP DRAWINGS OR MANUFACTURING. DIMENSIONS TAKE PREFERENCE OVER SCALE.

APPROVED SMOKE DETECTOR LOCATED ON OR NEAR CEILING TO COMPLY WITH AS 3708  
 SOLID WALLS INDICATE TIMBER CONSTRUCTION  
 HATCHED WALLS INDICATE BRICKWORK CONSTRUCTION

© 2014 MANCORP

CLIENT

PROJECT  
**PROPOSED RESIDENCE**

LOCATION  
**LOT 51  
 TEAL BOULEVARD  
 BANKSIA BEACH.**

ISSUE	DATE	DESCRIPTION
A	05/05/14	WORKING DRAWING

**CONSTRUCTION PLANS**

Date: 5/7/14

Signed: [Signature]

Checked: [Signature]

DATE: 05/05/14 SCALE: AS SHOWN

JOB NO. SHEET NO. 2 OF 8

**FLOOR PLAN**  
 SCALE 1:100