

**9 Sylvan Beach Esplanade Bellara QLD**

3 2 4

What a location. The Sylvan Beach Waterfront! Opportunity knocks to secure your place in the sun overlooking Pumicestone Passage and the beach right across the road.

This 3 bedroom plus study brick home is presented in superb condition and is now offered to the market. 9' ceilings throughout, ducted air conditioning, granite benchtops to the kitchen, family room plus lounge room with bar and a front terrace to sit and enjoy the vista! And to the rear is the 3 car garage.

Featuring;

- \* 3 bedrooms plus study/utility room
- \* 9' ceilings throughout
- \* 2 spacious living areas

[For full version visit the website](https://www.kdnorth.com.au)

**Type** : House  
**Price** : Contact Agent  
**Land Size** : 607 sqm  
**View** : <https://www.kdnorth.com.au/sale/qld/redcliff-e-bribie-caboolture/bellara/residential/house/7630644>



**Keith Wilkins**  
07 3410 7721

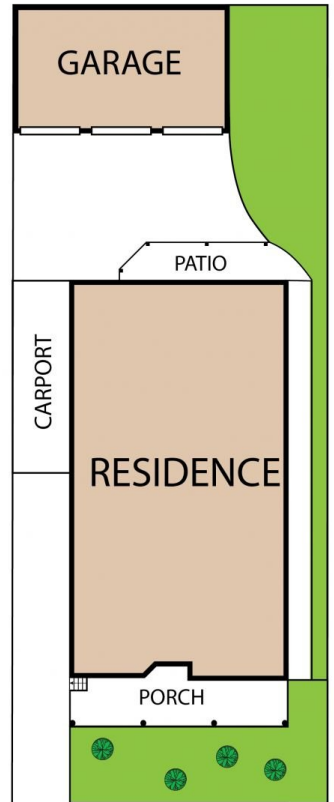
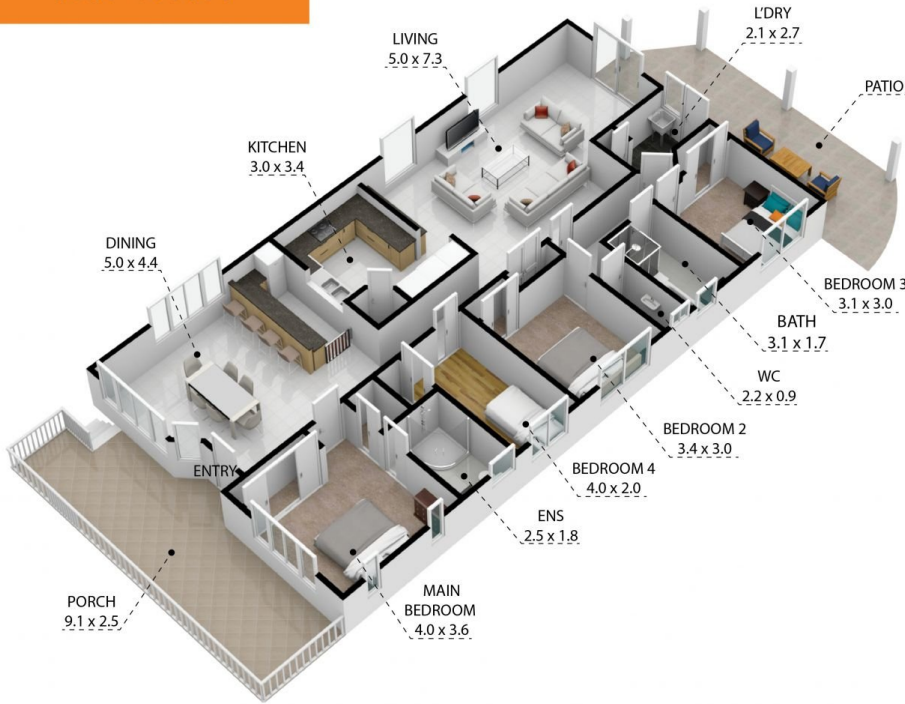

9 Sylvan Beach Esplanade, Bribie Island QLD, Australia, Bellara 4507

TOTAL APPROX. FLOOR AREA 185 SQ.M

Whilst every attempt has been made to ensure the accuracy of the floor plan contained here, measurements of doors, windows, rooms and any other items are approximate and no responsibility is taken for any error, omission, or misstatement. This plan is for illustrative purposes only and should be used as such by any prospective purchaser.

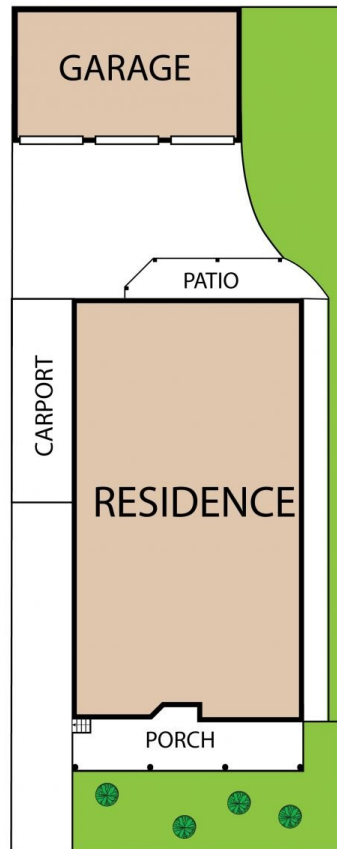

9 Sylvan Beach Esplanade, Bribie Island QLD, Australia, Bellara 4507

TOTAL APPROX. FLOOR AREA 185 SQ.M

Whilst every attempt has been made to ensure the accuracy of the floor plan contained here, measurements of doors, windows, rooms and any other items are approximate and no responsibility is taken for any error, omission, or misstatement. This plan is for illustrative purposes only and should be used as such by any prospective purchaser.