



65 Protea Drive Bongaree QLD

4 2 2

- * Centrally located in an excellent Bongaree Street.
- * Four bedroom, low set house.
- * Formal lounge & dining room PLUS tiled living area.
- * Good size Kitchen with plenty of cupboards/bench space.
- * AC in Lounge Room + Main Bedroom.
- * Two bathrooms (Ensuite off master bedroom).
- * Great sized undercover entertaining area.
- * Double garage + side access + hardstand + shed.
- * Fully fenced yard - pets on application.
- * Solar power.

Land Size : 600 sqm

View : <https://www.kdnorth.com.au/lease/qld/redcliff-fe-bribie-caboolture/bongaree/residential/homeuse/7895268>



Kelly Baldwin
07 3410 7721

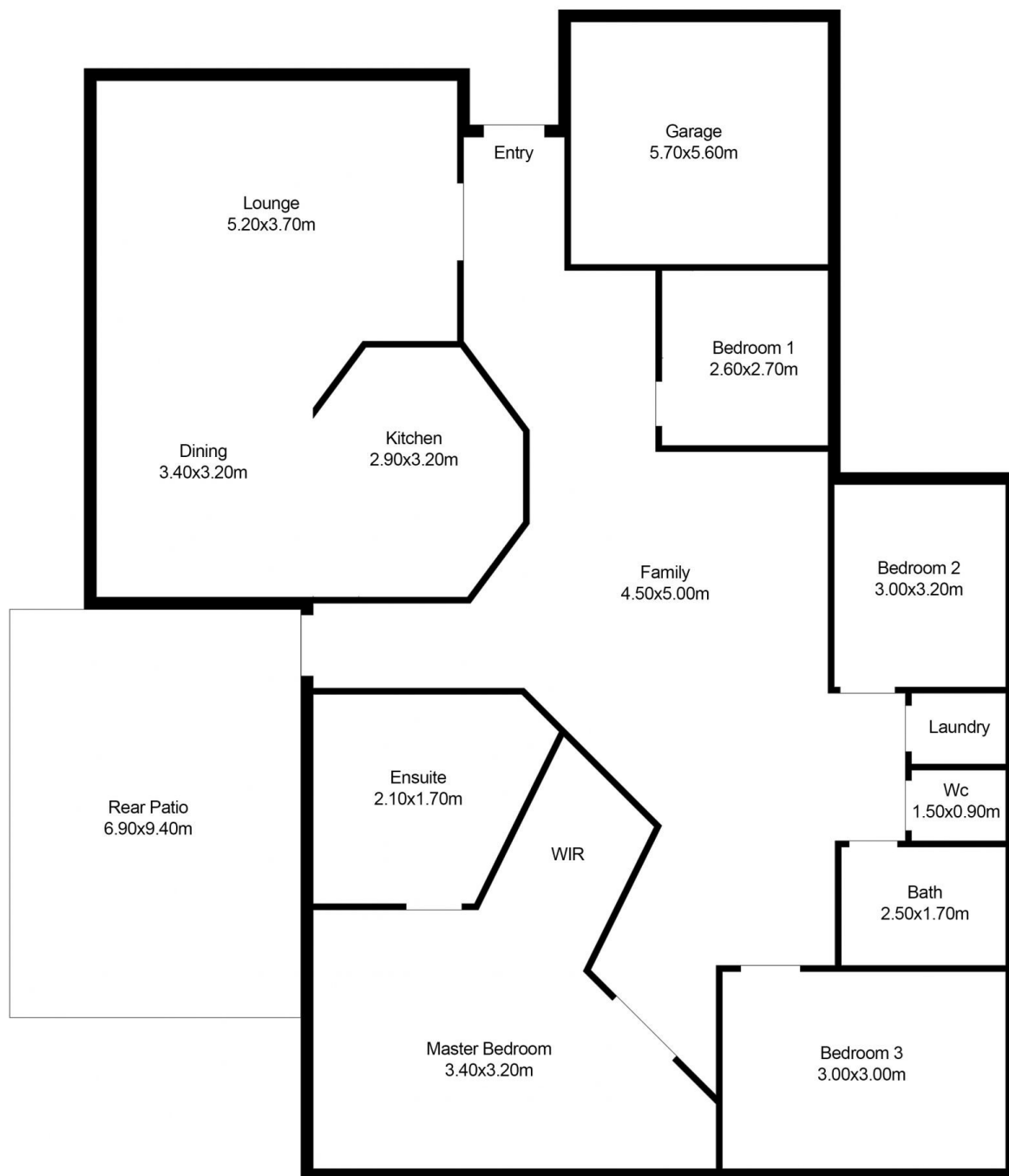

FLOOR PLAN

This floor plan including furniture, fixture measurements and dimensions are approximate and for illustrative purposes only. BoxBrownie.com gives no guarantee, warranty or representation as to the accuracy and layout. All enquiries must be directed to the agent, vendor or party representing this floor plan.

65 Protea Drive, Bongaree